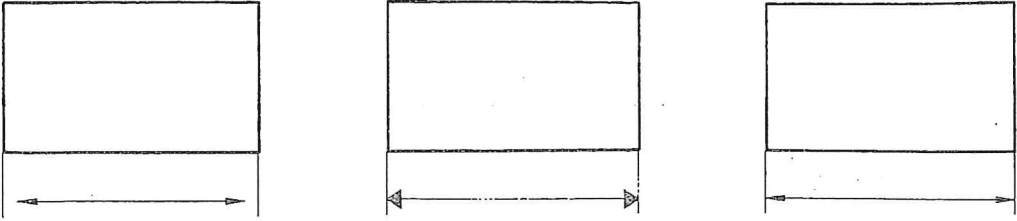
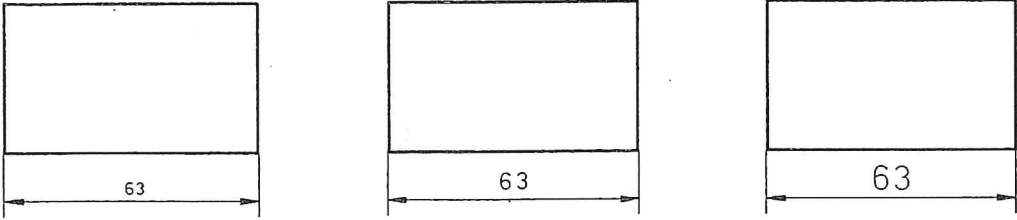
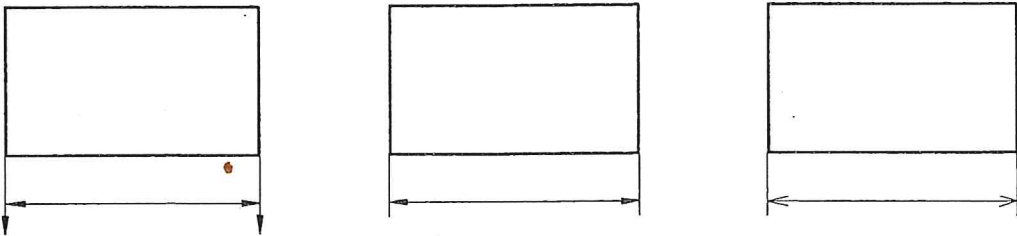

# 1. ACOTACION

Indicar la solución correcta colocando una X en el cuadrado correspondiente:

1. 

2. 

3. 

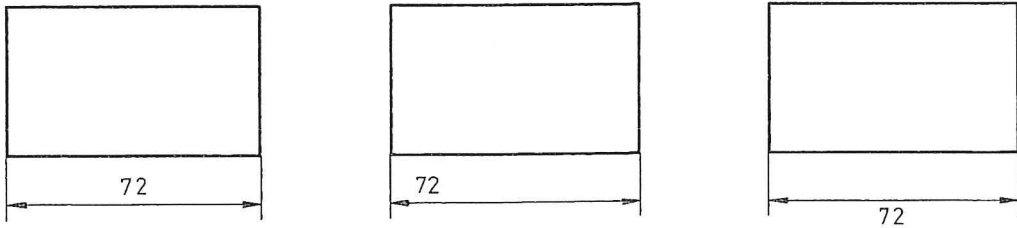
4. 

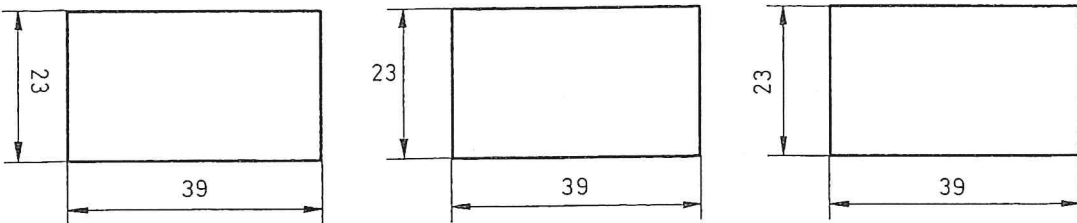
5. 

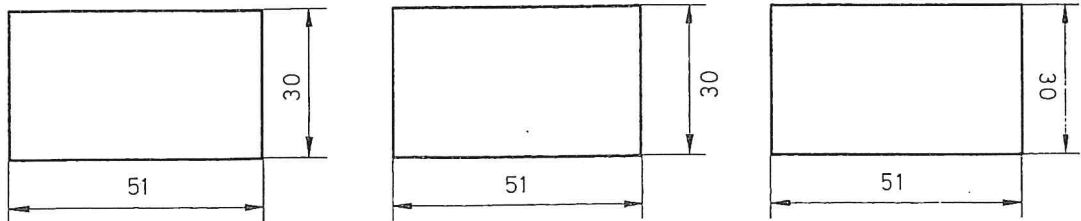
6. 

7.

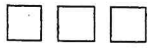
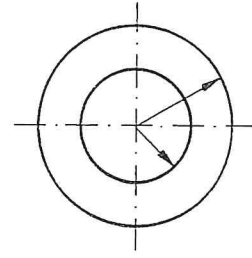
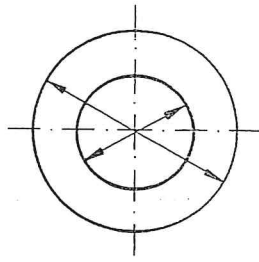
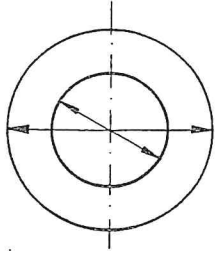

8.

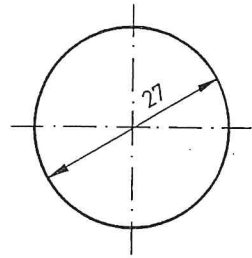
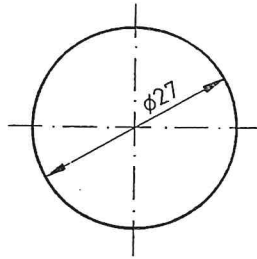
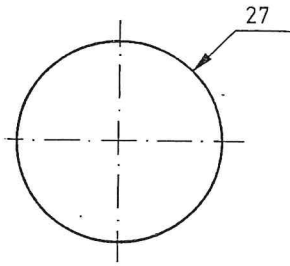

9.

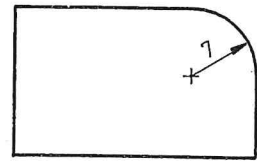
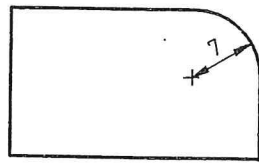
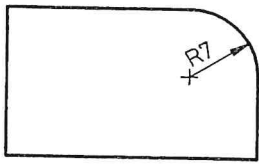

10.

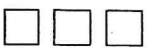
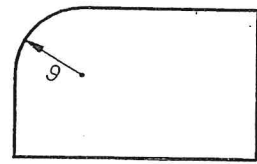
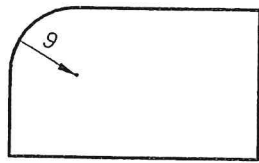
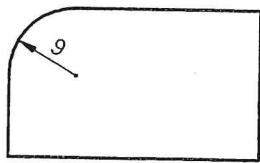

11.

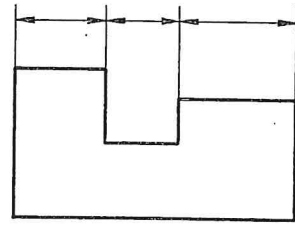
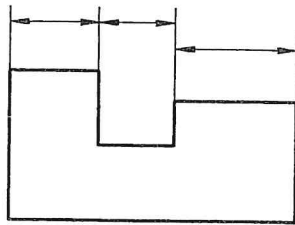
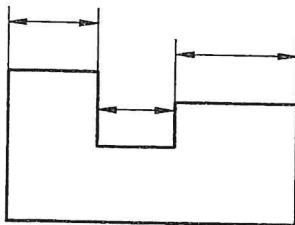

12.

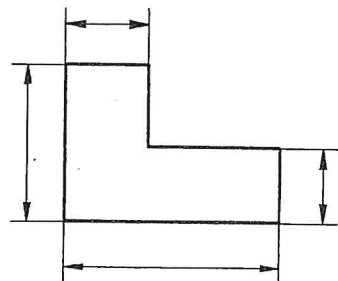
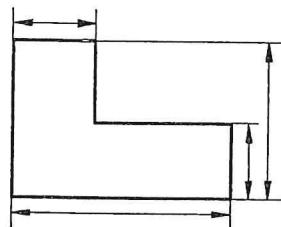
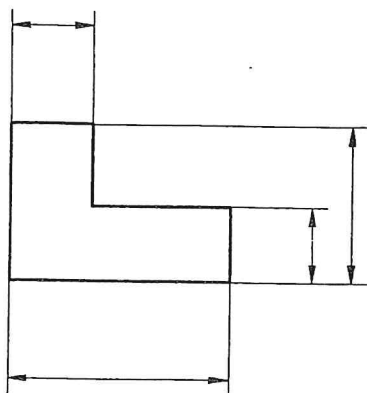

13.

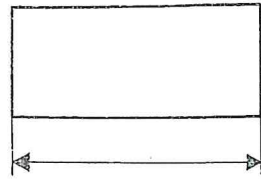
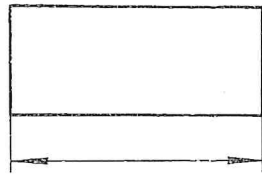
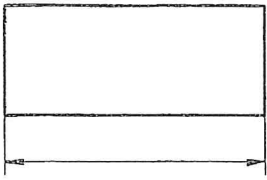

14.

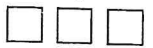
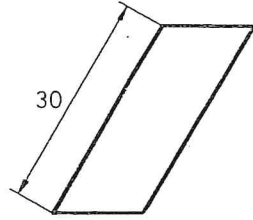
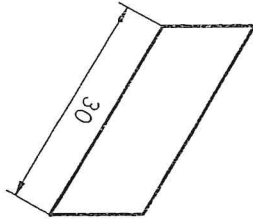
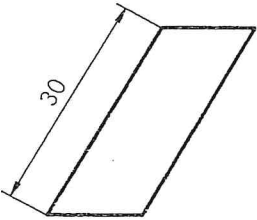

15.

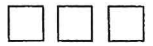
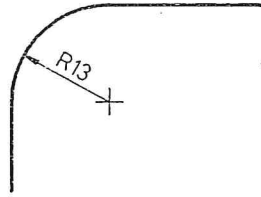
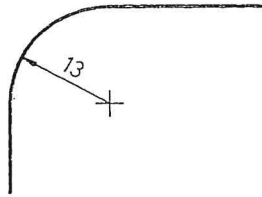
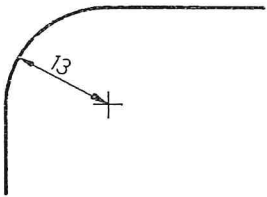

16.

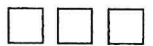
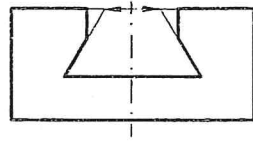
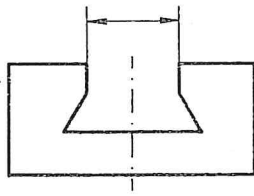
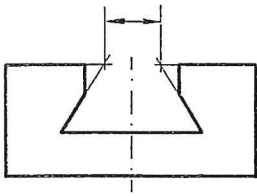

17.

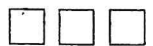
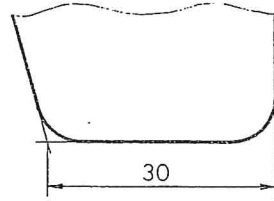
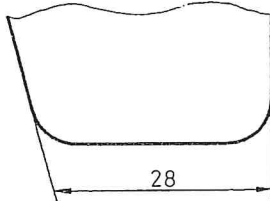
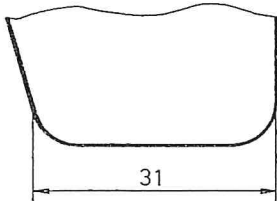

18.

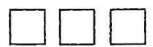
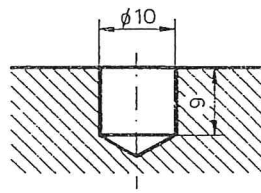
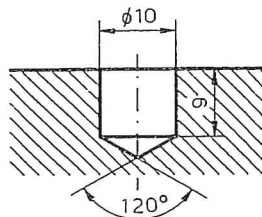
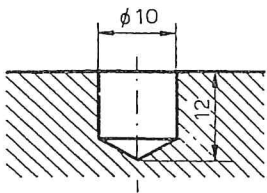

19.

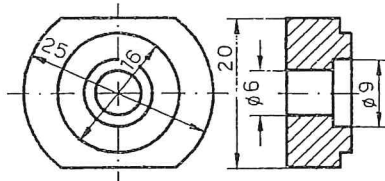
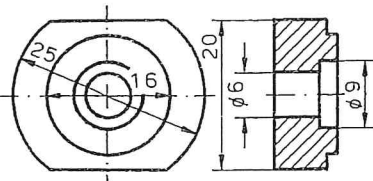
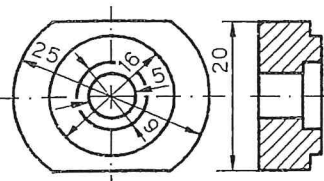

20.

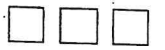
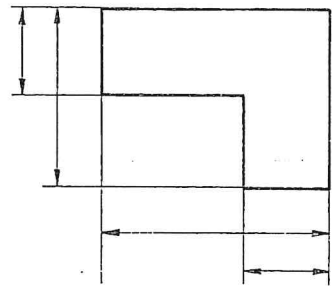
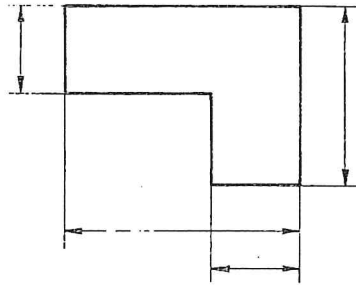
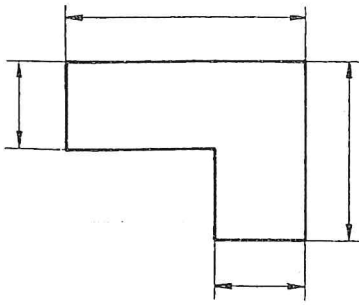

21.

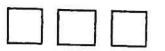
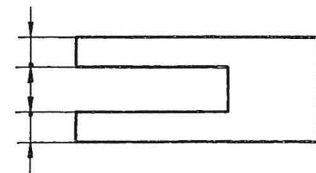
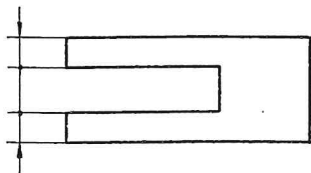

22.

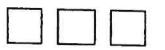
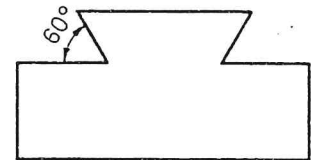
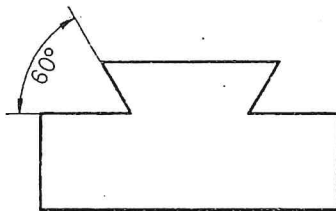
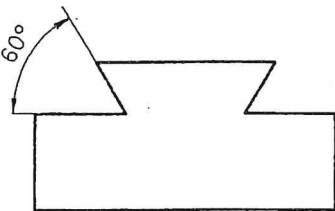

23.

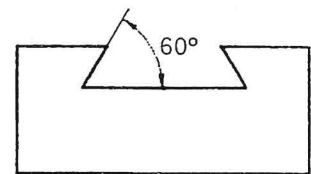
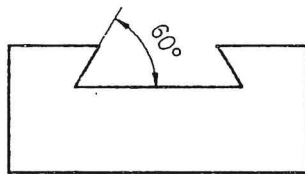
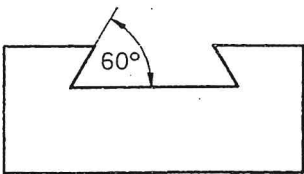

24.

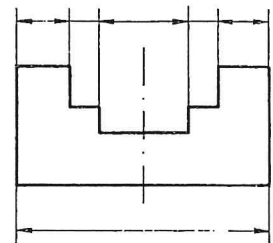
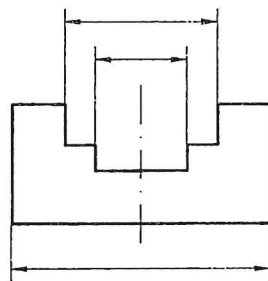
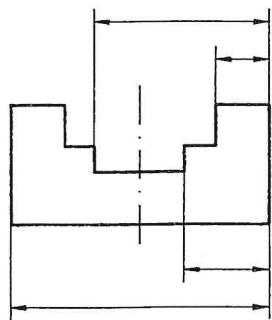

25.

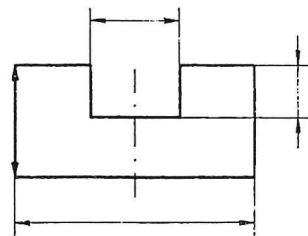
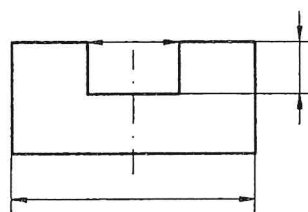
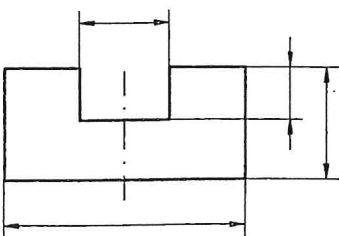

26.

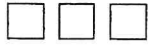
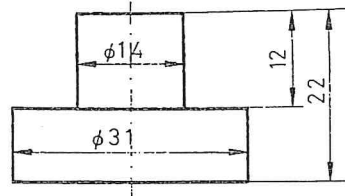
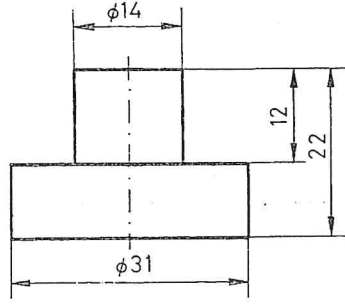
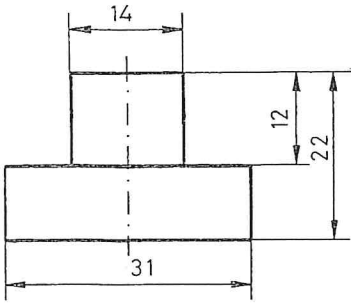

27.

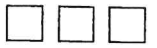
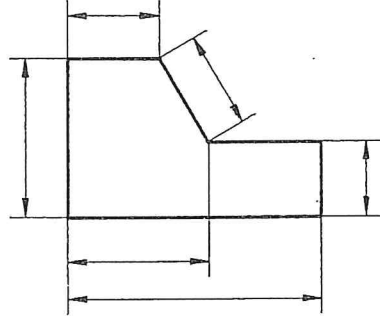
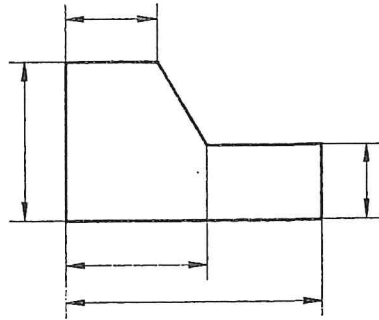
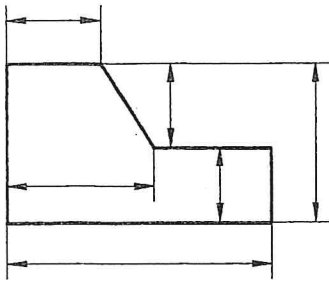

28.

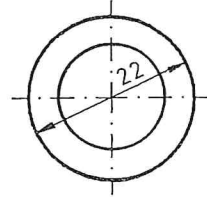
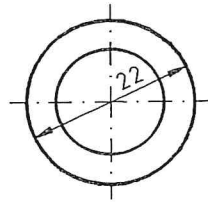
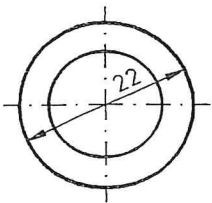
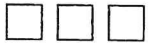
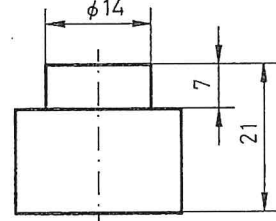
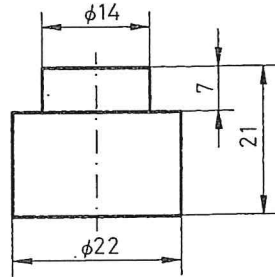
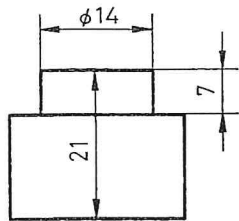

29.

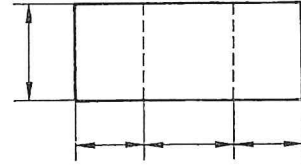
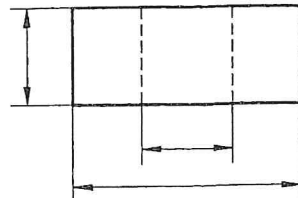
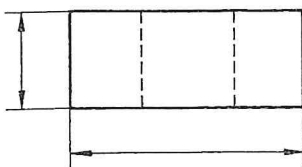
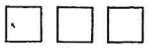
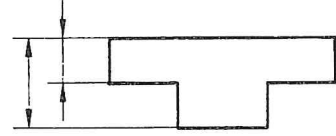
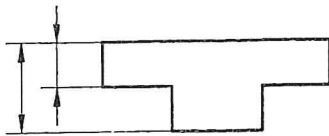
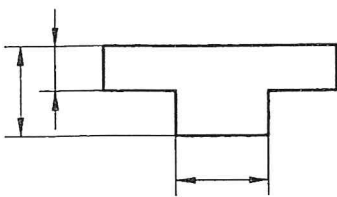

30.

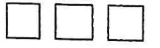
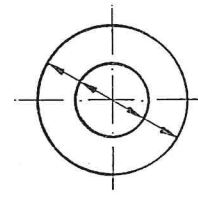
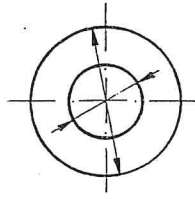
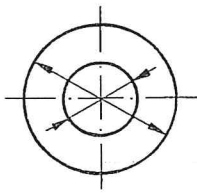

31.

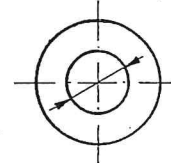
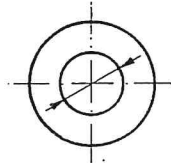
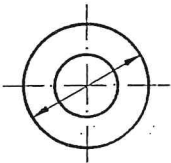
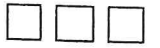
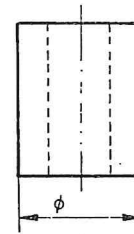
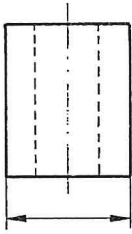
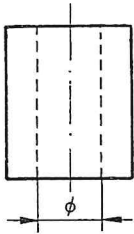

32.

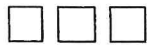
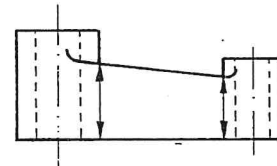
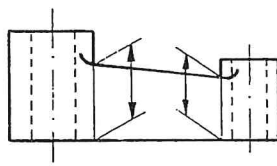
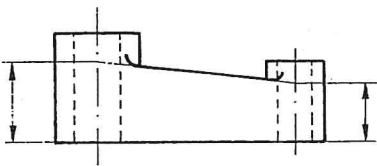

33.

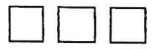
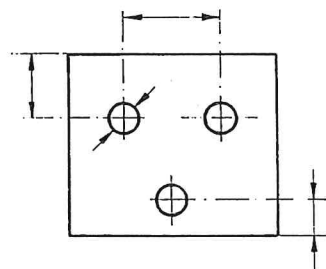
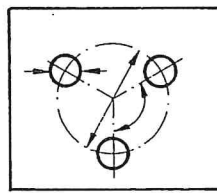
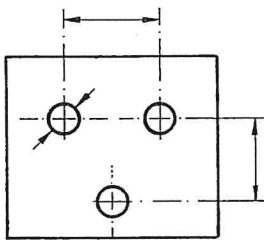

34.

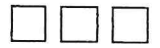
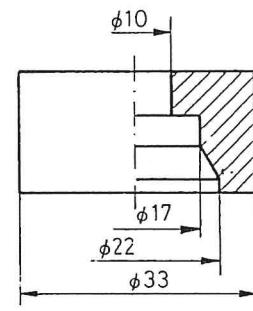
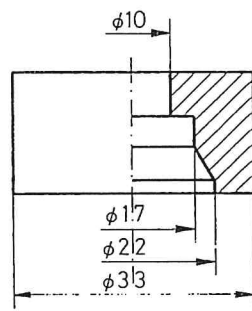
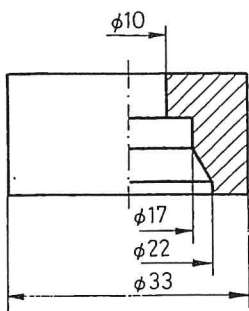

35.

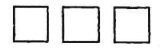
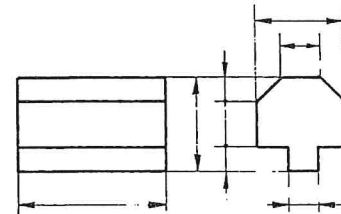
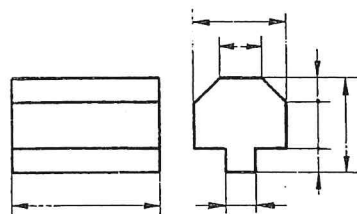
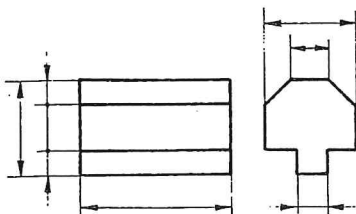

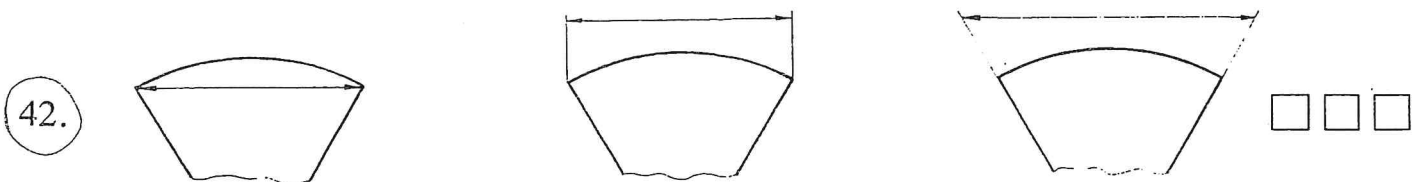
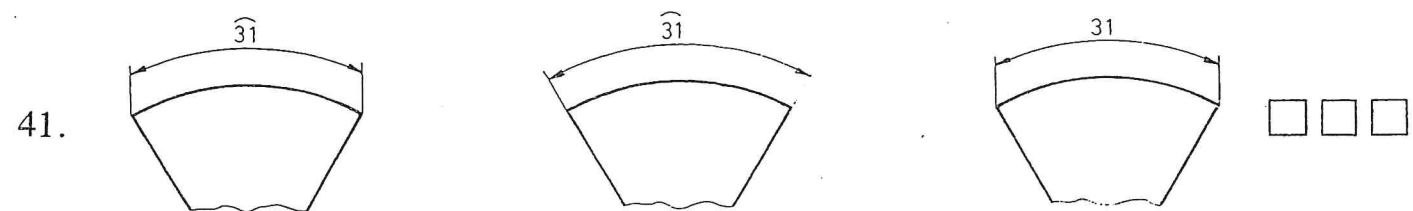
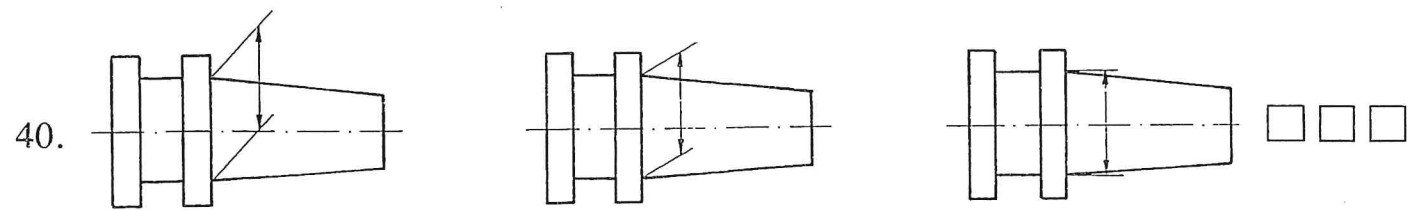
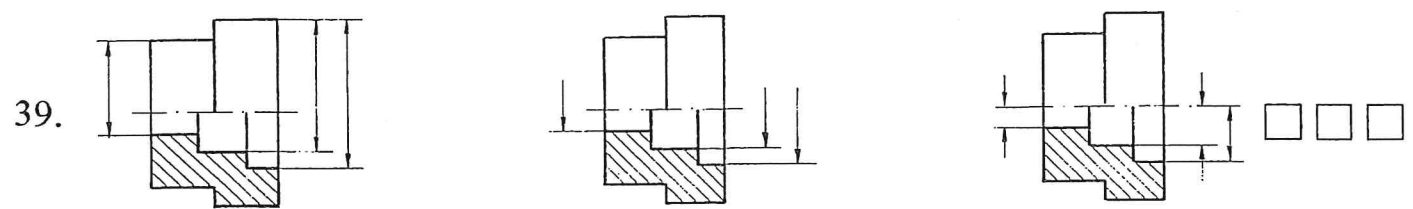
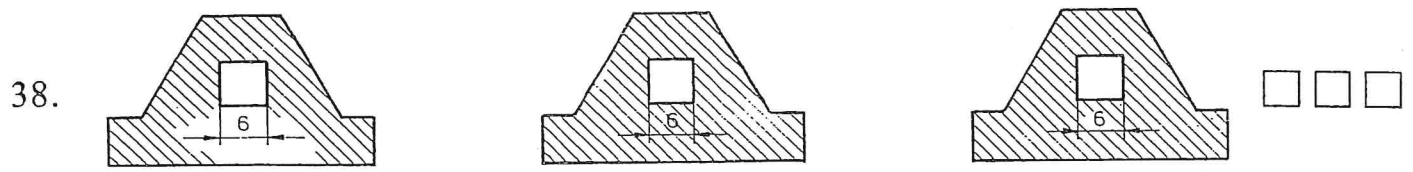
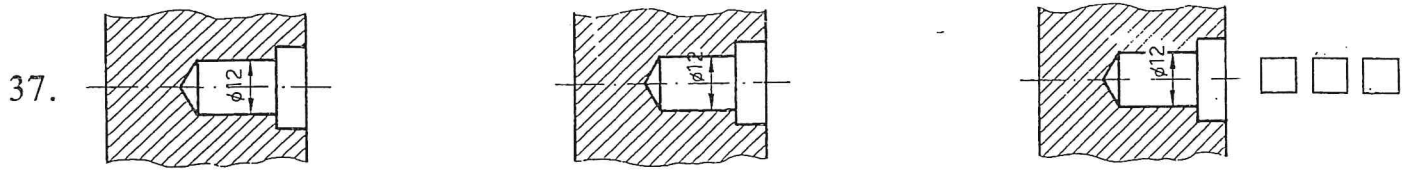
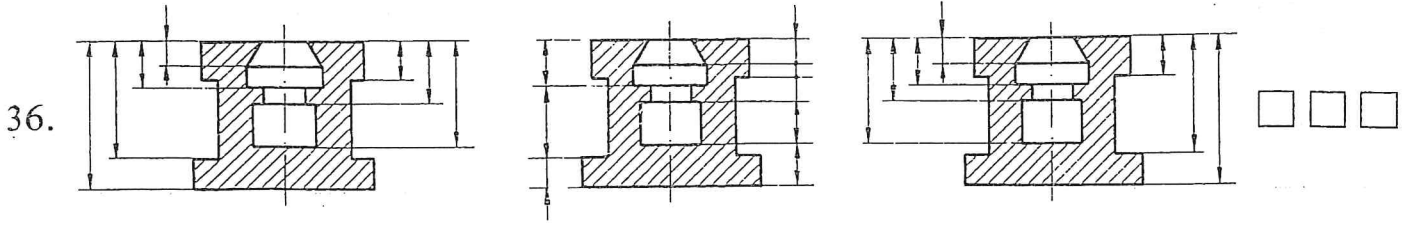

Indicar si son verdaderas o falsas las proposiciones que siguen (colocar una X dentro del cuadrado correspondiente):

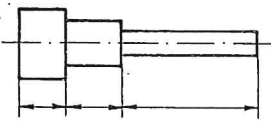
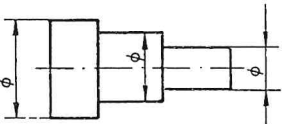
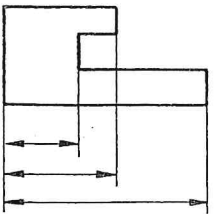
- |  | V                        | F                        |
|--|--------------------------|--------------------------|
| 43. Los sistemas de acotación son las diferentes formas de fabricar una pieza .....  | <input type="checkbox"/> | <input type="checkbox"/> |
| 44. Los sistemas de acotación son las diferentes formas de colocar las líneas de cota en los dibujos .....   | <input type="checkbox"/> | <input type="checkbox"/> |
| 45. El sistema de acotación que se empleará en cada caso puede elegirse de acuerdo con el proceso de fabricación .....   | <input type="checkbox"/> | <input type="checkbox"/> |
| 46. La acotación por simetría es un sistema de acotación .....   | <input type="checkbox"/> | <input type="checkbox"/> |
| 47.  La pieza del dibujo está acotada en paralelo .....                         | <input type="checkbox"/> | <input type="checkbox"/> |
| 48. Hay tres criterios diferentes que pueden tenerse en cuenta al acotar una pieza ....  | <input type="checkbox"/> | <input type="checkbox"/> |
| 49. Las piezas prismáticas asimétricas, de acuerdo con el proceso de fabricación, se acotan en paralelo .....  | <input type="checkbox"/> | <input type="checkbox"/> |
| 50. Los diámetros de las piezas de revolución se acotan en serie .....   | <input type="checkbox"/> | <input type="checkbox"/> |
| 51. Los perfiles irregulares de piezas forjadas o troqueladas pueden acotarse por coordenadas .....  | <input type="checkbox"/> | <input type="checkbox"/> |
| 52. Al acotar las piezas dobladas y curvadas se ha de anotar la distancia interior de los puntos de doblado .....  | <input type="checkbox"/> | <input type="checkbox"/> |
| 53.  Los diámetros de la pieza representada se han acotado por simetría ..... | <input type="checkbox"/> | <input type="checkbox"/> |
| 54. Para acotar una pieza se tendrá en cuenta alguno de los criterios siguientes: función, representación o visualización .....                                  | <input type="checkbox"/> | <input type="checkbox"/> |
| 55.  Las cotas de la pieza dibujada se han situado en paralelo ...            | <input type="checkbox"/> | <input type="checkbox"/> |
| 56. Cuando las distancias entre elementos contiguos de una pieza sean muy importantes, se acotarán en serie .....  | <input type="checkbox"/> | <input type="checkbox"/> |
| 57. Las cotas, de acuerdo con su función, pueden ser funcionales, no funcionales y mixtas  | <input type="checkbox"/> | <input type="checkbox"/> |